

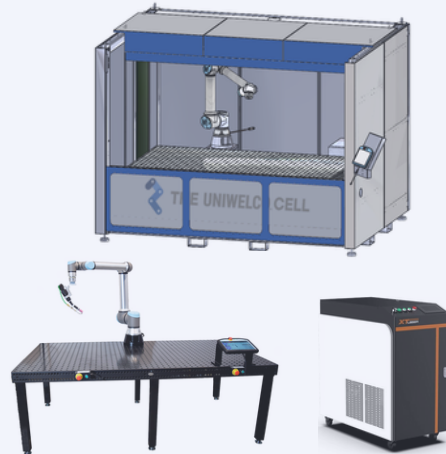

# THE FIBERLASER CELL 2000W

## THE FIBERLASER CELL

- Universal Robot UR10e
- Fiber Laser Welding 2000W
- Welding Table, 2400x1200
- URCap, Uniwelco's software



## Additional Options:

- Turntable
- Tailstock

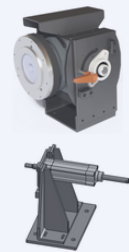

## Specifications:

- Length: 3300mm
- Wide: 2400mm
- Height: 2300mm
- Weight: 2200kg

## Approvals:

- Approved CE
- EN 60204-1
- EN ISO 10218-2
- EN ISO 13849-1

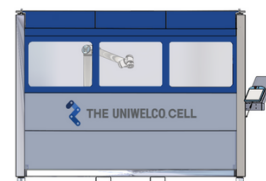

## CE marked:

All machines require CE-marking, which can be an extensive process.

As Uniwelco ApS has specialist knowledge in the industry, we have chosen not to take any risks when it comes to safety and CE-marking. This is why, RBCobots are CE-marked by Danish Safety of Machinery ApS, that goes through all material as well as continuously monitors standards, so that RBCobot always abides applicable regulations.

This ultimately gives us more time to refine RBCobot and provide you with more peace of mind.



**RBCobot**

Powered by UNIWELCO software

Excluding VAT, Ex factory - All prices are valid from:  
The 11th of September till the 31st of December 2023

Jens Juuls Vej 15, 8260 Viby J - [www.uniwelco.com](http://www.uniwelco.com)  
+45 70 60 20 62 - [info@uniwelco.com](mailto:info@uniwelco.com)



**UNIVERSAL ROBOTS+**  
Certified



## More Products From Uniwelco ApS

### MIG / MAG - Water cooled

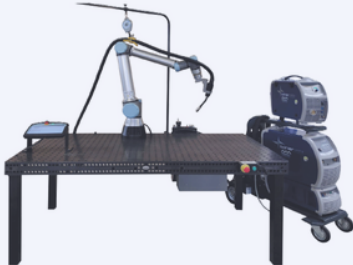

#### Power Supplies:

MIG / MAG: Böhler water cooled 320A  
MIG / MAG: Böhler water cooled 400A  
MIG / MAG: Böhler water cooled 500A

#### Welding Features:



### TIG - Coldwire

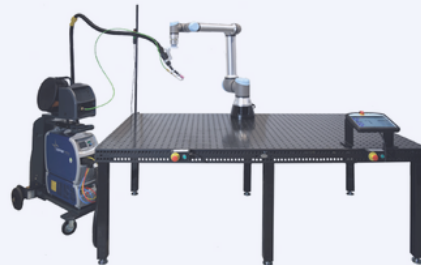

#### Power Supplies:

TIG: Böhler (cold wire) water cooled: 320A AC/DC  
TIG: Böhler (cold wire) water cooled: 400A AC/DC

#### Welding Features:



QuickPulse 2.0 ensures an extremely stable and concentrated arc, which increases the penetration (depending on material)



RapiDeep 2.0 adjusts and controls the power supply very efficiently. This reduces the heat-affected zone and produces visually pleasing welding beads.