



PRESENTATION

GYS Group

www.gys.fr



CONTENTS

1	THE GROUP	3
	1.1 Family-owned group	4
	1.2 Key figures	5
	1.3 Technology as a driver for development	6
2	DESIGN AND PRODUCTION	7
	2.1 R&D, a centre of excellence and expertise	8
	2.2 Committed to quality from start to finish	9
	2.3 100% integrated manufacturing process	10
	2.4 An international logistics centre to support the global market	11
	2.5 Responsive, in-house after-sales service	12
3	PRODUCTS AND SERVICES	13
	3.1 Distribution channels	14
	3.2 Three specialist catalogues	15
	3.3 Global sales team	16
	3.4 Training courses: sharing technical knowledge	17
	3.5 Available communication tools	18



1

THE GROUP



1. The group

A STRONG FAMILY-OWNED GROUP

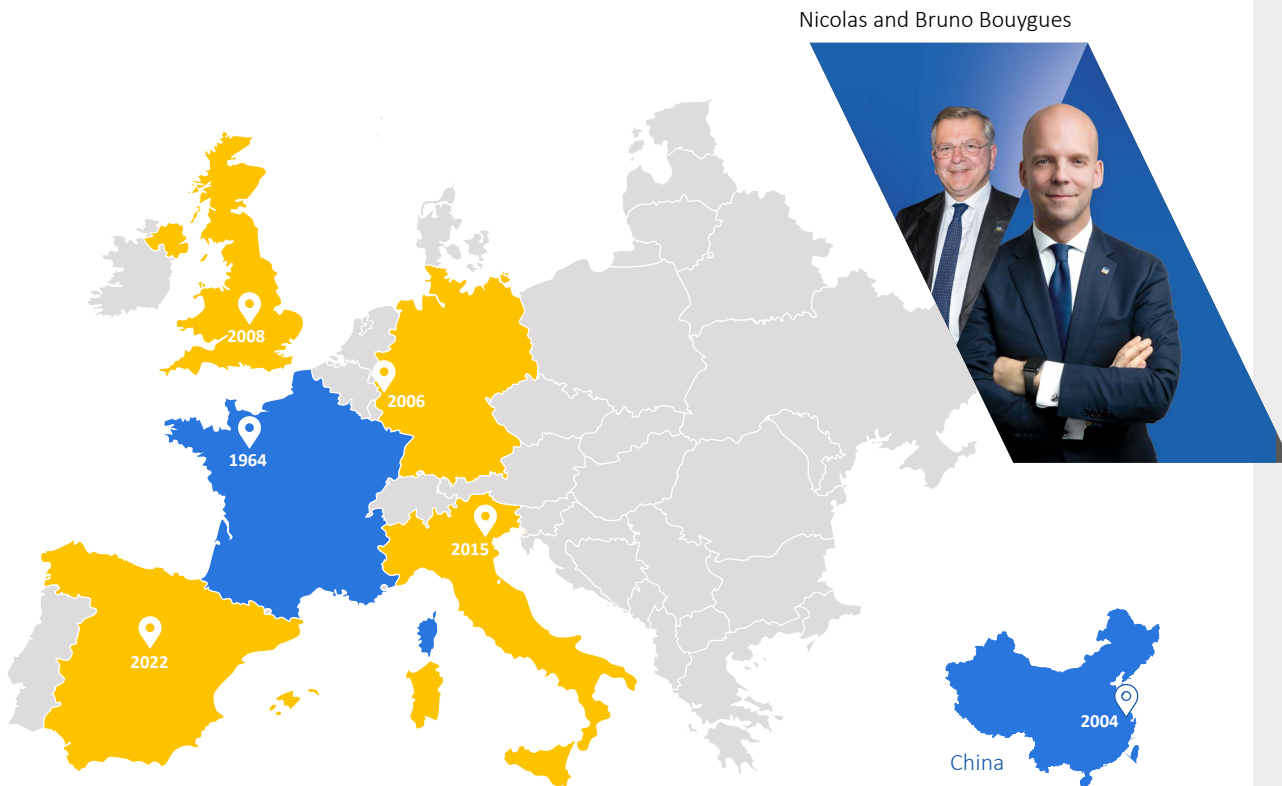

2
production
FACTORIES

1
Global logistics
PLATFORM

6
SUBSIDIARY
offices

132
COUNTRIES
served

Logistics centre
Building a second
logistics facility (9,500 m²)

2022

Spain
Opening a subsidiary sales
office in Madrid

2021

Extension
Built a new manufacturing
facility in Laval (5,600 m²)

2020

Logistics centre
Built a dedicated logistics
centre (9,500 m²)

2015

Italy
Opened a subsidiary sales
office in Venice

2014

R&D
Opened a new R&D
centre in Laval

2008

United Kingdom
Opened a subsidiary sales
office in Rugby

2006

Germany
Opened a subsidiary sales
office in Aachen

2004

Second factory
Built a second production
facility in China (Shanghai)

1997

Acquisition
GYS was taken over by the
current managing family

1964

Established
Founded by Guy-Yves
Stéphany for manufacturing
transformers



KEY FIGURES*



In 2022,



125
million Euro turnover



900
employees worldwide



53 000 m²
of floor space worldwide



5%
of turnover each year
reinvested into R&D



C1+
Rating at the Banque
de France

*until the 31/12/2022

Three business areas



50%

**WELDING
& CUTTING**



30%

**CAR-BODY
REPAIRS**



20%

**BATTERY
CHARGING**

A family-owned business enjoying 15 years of continuous growth

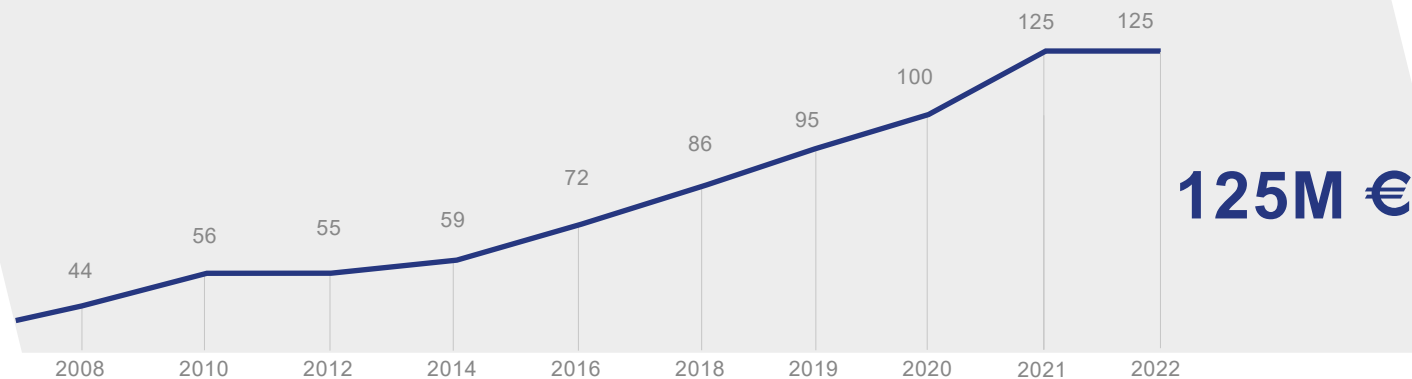

125M €

TECHNOLOGY AS A DRIVER FOR DEVELOPMENT

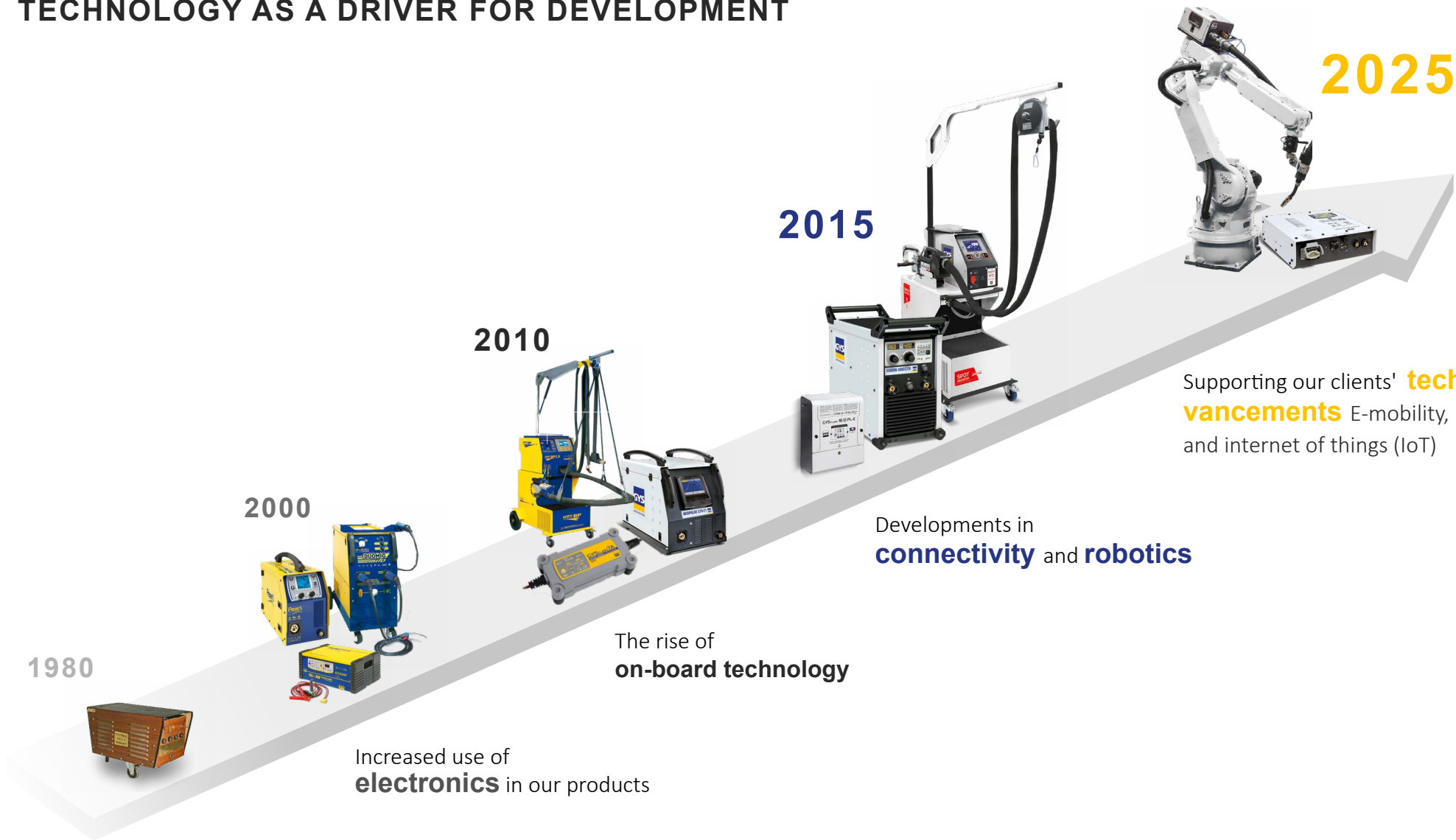

1980



Increased use of **electronics** in our products

2000



The rise of **on-board technology**

2010



Developments in **connectivity** and **robotics**

2015



2025



Supporting our clients' **technological advancements** E-mobility, robotics and internet of things (IoT)

Traditional, professional products with **built-in transformers**

2

DESIGN & PRODUCTION



R&D: A CENTRE OF INNOVATION AND EXPERTISE



+90
specialist experts

- Experts with PhDs in the field of power electronics
- Engineers specialising in on-board computer systems
- Engineers specialising in fluid mechanics
- Engineers specialising in plastics
- Engineers specialising in mechanical design
- Engineers specialising in radio frequencies



+50
innovative products
designed every year



4
areas of expertise

- **Electronics:**
Developing power/digital circuit boards
- **Mechanical engineering:**
Designing clamps, sheet metal, plastics and welded structures, etc.
- **On-board computing:**
Developing Human Machine Interfaces (HMI), welding modes, control algorithms, and communication systems (Bluetooth / Wi-Fi)
- **Robotics:**
Communication interfaces, robotic wire-feed reels, UR-Cap software and installation files



COMMITTED TO QUALITY FROM START TO FINISH

Twenty two dedicated staff for approving and improving products and processes



Conformity

- Conforms with current standards (20 European directives, 400 standards)
- Component and endurance testing
- Simulated meteorology conditions

→ **Complies with regulations**



Production testing

- Manufacturing testers
- Normative and functional testing
- The product's traceability feature

→ **Quality control**



Quality

- Monitoring and control systems for component parts and products
- Improving products and processes
- Environmental assessments

→ **Certification**
ISO 14001 / ISO 9001

2. Design and production

100% INTEGRATED MANUFACTURING PROCESS

In-built expert knowledge to guarantee versatility, responsiveness and quality

Electronics

72 million component parts installed each year

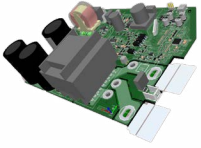

Transformers

150,000 transformers / chokes manufactured each year

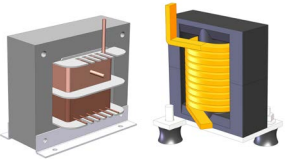

Mechanics

720,000 parts machined each year

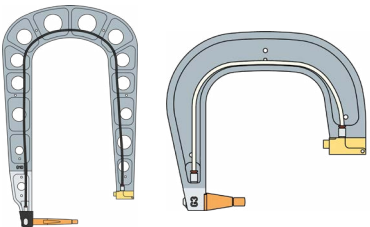

Sheet metal work

1,400 tonnes of sheet metal folded and cut sheet each year

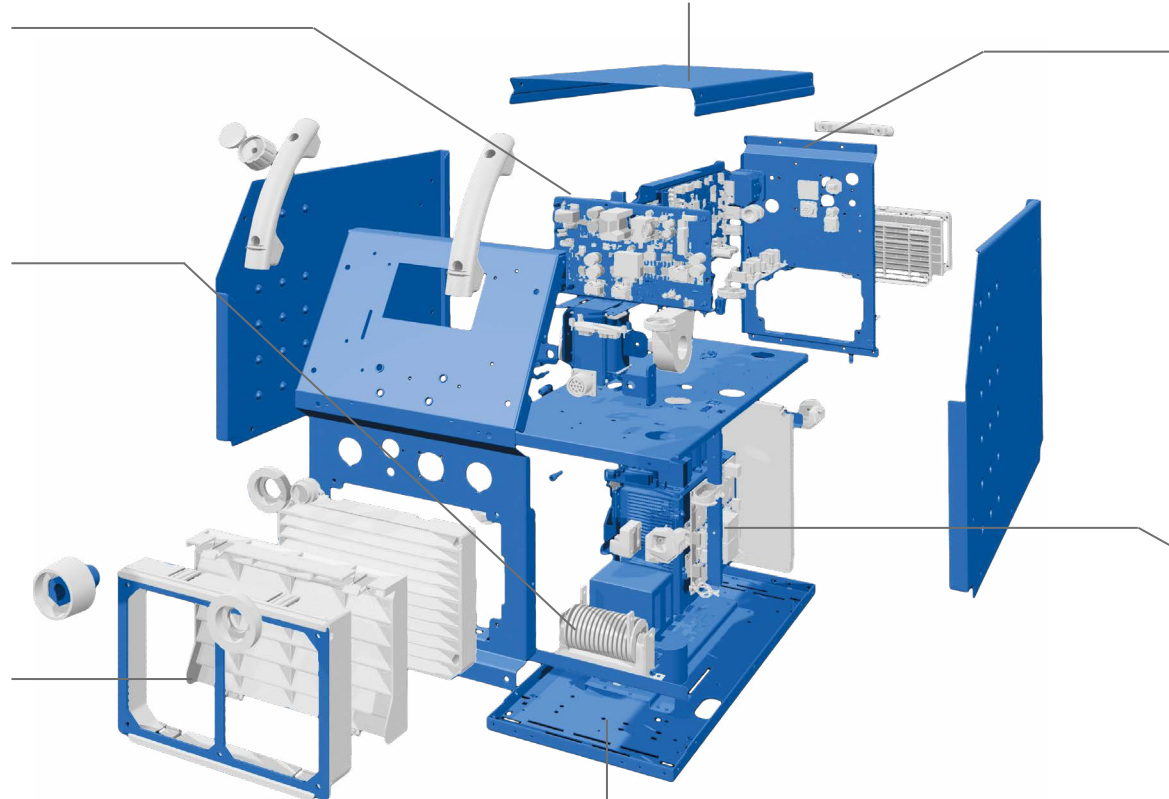

Painting

160,000 m2 of painted surfaces

Assembly

Twenty assembly lines



Wiring

250 km of wire cut and crimped each year



AN INTERNATIONAL LOGISTICS CENTRE TO SUPPORT THE GLOBAL MARKET

Permanently and fully stocked warehouses all year round



1 international logistics centre

An international logistics centre in France (Laval).



3,300 parts in stock all year round

Three local warehouses in our British, German and Chinese subsidiary offices.



1 million products shipped worldwide each year

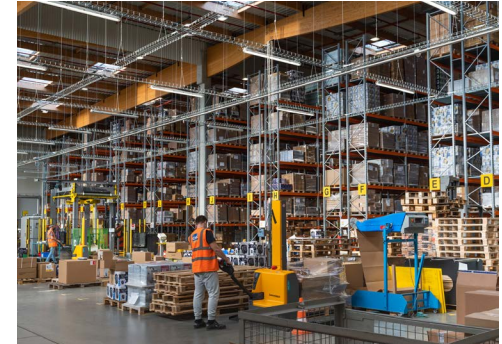
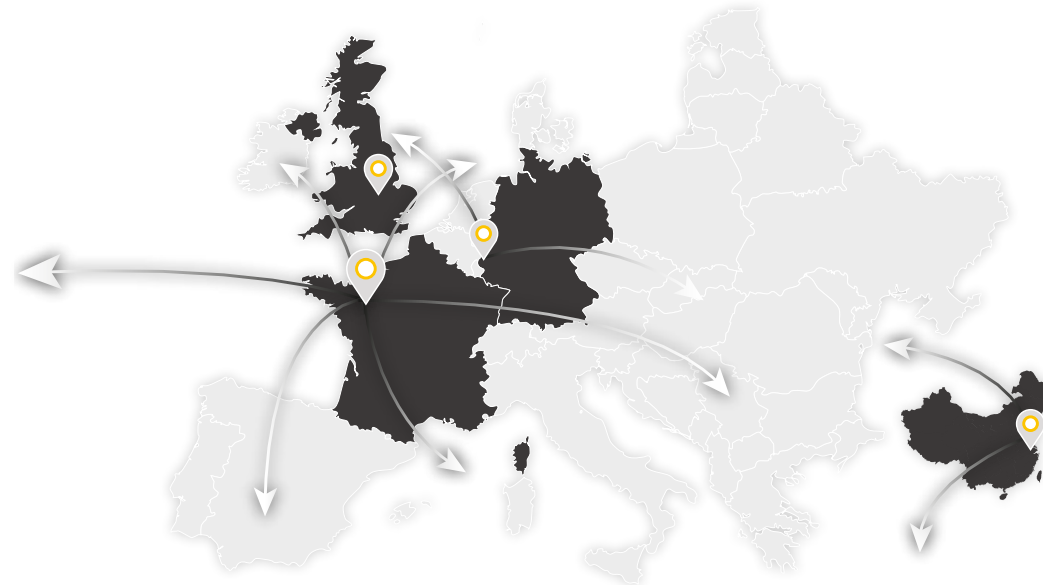

-48h our European target delivery time

AN INTEGRATED & RESPONSIVE AFTER-SALES SERVICE



2 areas
of expertise

inverter servicing / traditional servicing



32 technicians
Repair staff



+1,000

spare parts

manufactured in our workshops



2 year
warranty

Planet GYS: a platform created and designed for our customers

- Commercial contacts' contact details
- Pre-diagnosis, after-sales declaration
- Get a quote in just a few clicks
- Real-time monitoring of the repair process
- Spare parts lists and prices
- Technical documents
- Product software updates

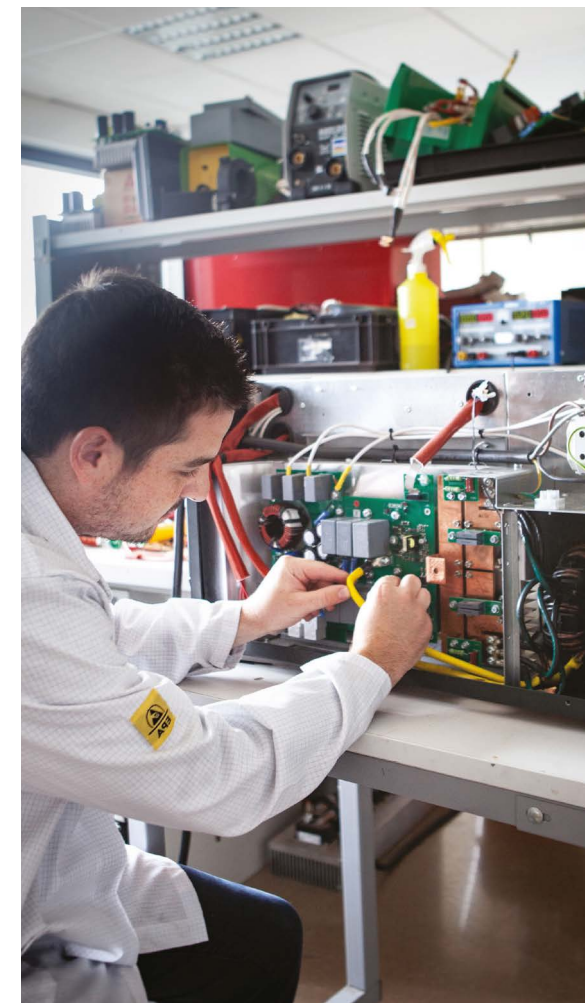

PRODUCTS & SERVICES

3



DISTRIBUTION CHANNELS



Perfectly suited products for many industrial sectors

Thanks to a wide range of products in its three business areas, GYS is able to meet the needs of all users in a variety of industrial sectors.

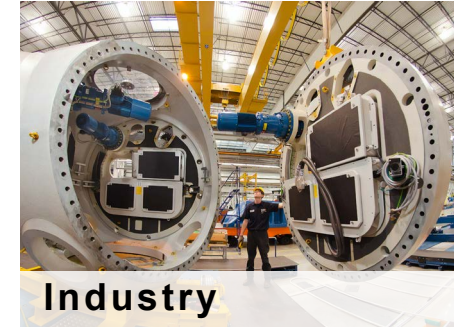

THREE SPECIALIST CATALOGUES



WELDING & CUTTING

50%

+ 350 parts
+ 1,250 accessories and consumables

CAR-BODY REPAIRS

30%

+ 200 products
+ 850 accessories and consumables

BATTERY CHARGING

20%

+ 190 products
+ 200 accessories and consumables

Welding & Cutting
Consumables
Accessories

Dent removal
Spot welding
Dent pulling
MIG welding
Lifting
Induction heating
Riveting

Chargers
Boosters and starters
Accessories

3. Products and services

GLOBAL SALES TEAMS

Our brand is present in France and worldwide thanks to our network of local distributors, importers & agents



Our multidisciplinary sales team consists of **170 people** and covers 132 countries, including France. They are available to serve customers and to support them on a daily basis. **The GYS group guarantees that its products are sold exclusively to its distributors, importers and local agents.**

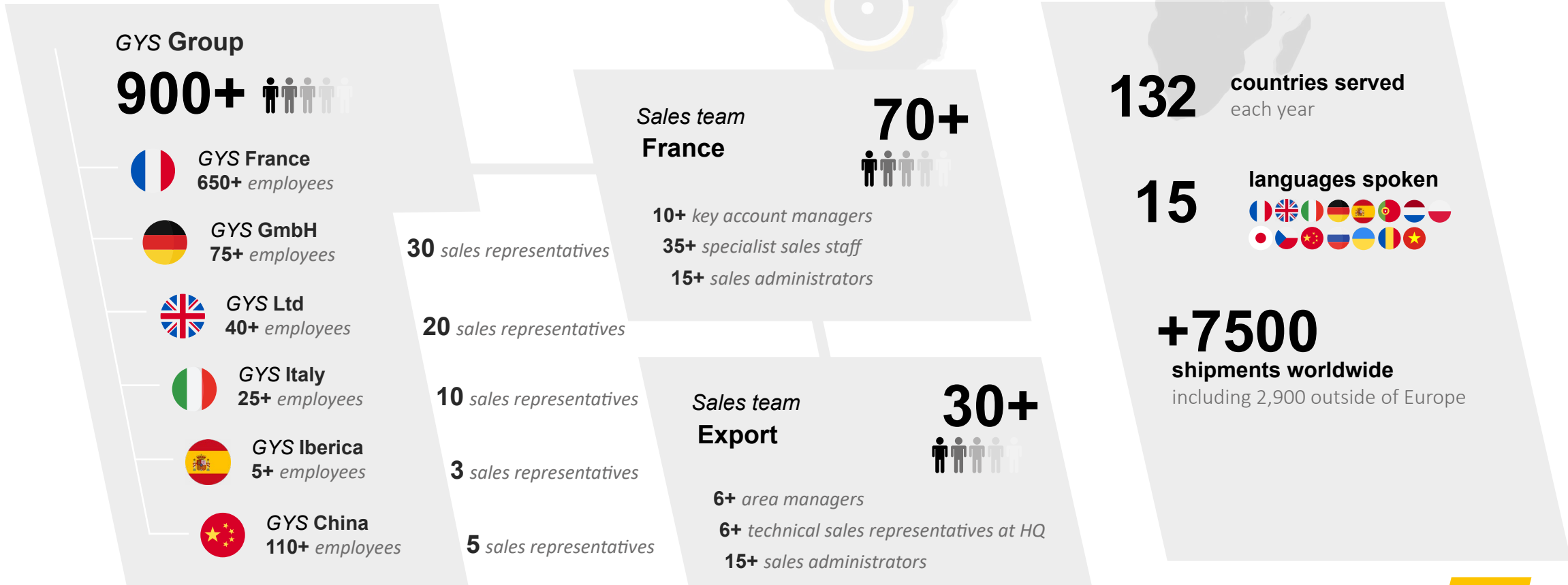

GYS ACADEMY TRAINING: shared technical knowledge

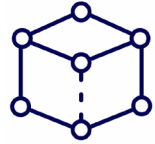
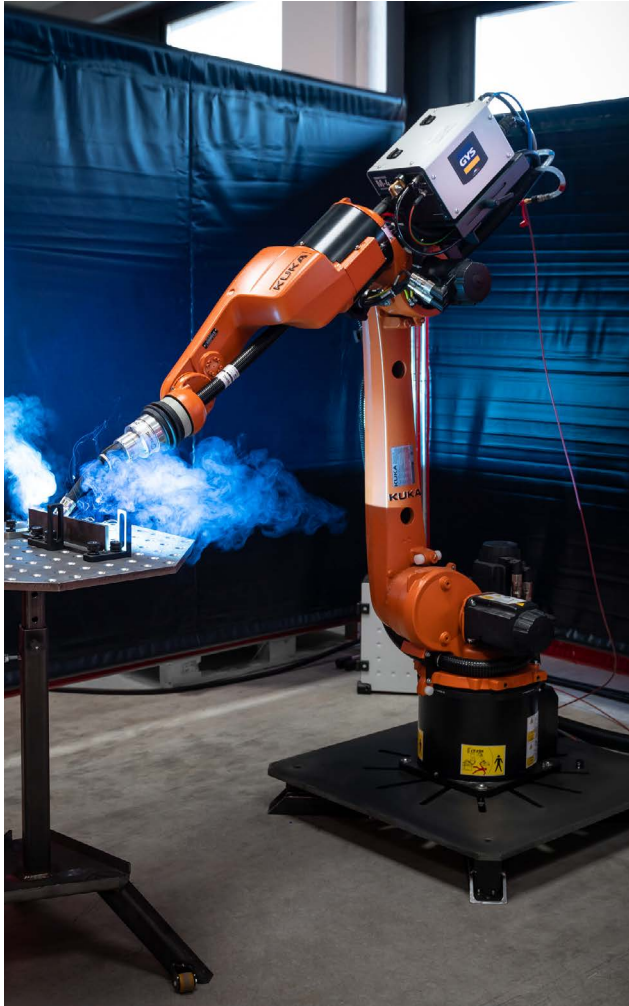

400 m²

GYS Academy

devoted entirely to training



200

people trained each year

Distributors, partners,
sales team, employees, etc.



+50 video

tutorials on YouTube

to support you at home

- **Charger showroom**
- **Welding showroom**
- **Car bodywork showroom**
- **Detailed courses are available** on our extranet

Experts on hand to train you

Five experts will guide and train you in how to use our products: MMA, MIG/MAG, TIG, plasma, induction heating, spot welding and battery charging.



AVAILABLE COMMUNICATION TOOLS

A marketing /design team at your service



Sales support tools

- Product catalogues
- Detailed technical data sheets
- Brochures
- Flyers
- Leaflets
- Packaging
- Customising the products

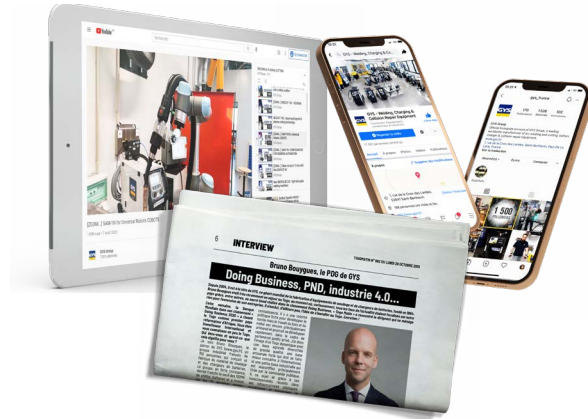

Multimedia communication

Videos available on our YouTube channel

- Video tutorials
- A closer look at our technologies and features
- New product introductions

Social networks

- Find out more about GYS at [f](#) [in](#) [v](#) [i](#) [d](#)

Media relations

- GYS in the news (local and industry-specific press)

Image library

- Find all images of GYS products by downloading them free from our website

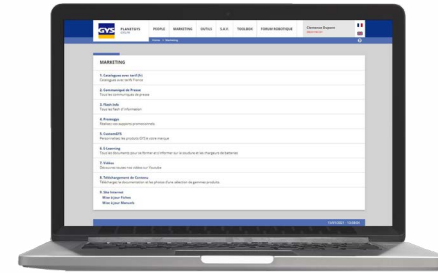

An easy-to-use customer extranet

Information available

- Order tracking
- Sales representative contact details
- Technical information
- E-learning: welding and charging training courses

Marketing tool

- Promogys : promotional campaign creation tool

After-sales service area

- Follow-up and approve current quotes
- Spare parts list and wiring schematics
- Downloading software updates
- Repair procedures



Technical documents

- User manuals
- Declarations of conformity
- Download visuals



www.gys.fr



GYS France - Headquarters

1, rue de la croix des Landes
CS 54159
53941 SAINT-BERTHEVIN Cedex
Laval – France
Tel: +33 2 43 01 23 60
E-mail: contact@gys.fr

LOGISTIC CENTRE

2, rue Jean Dausset
53910 Changé – France
Tel: +33 2 43 01 54 33

Take a look behind the scenes
in our company video.



GYS GERMANY

Professor-Wieler
Straße 11
52070 Aachen
Germany
Tel: +49 241 / 189-23-710
E-mail: aachen@gys.fr



GYS UK

Unit 3
Great Central Way
Rugby – Warwickshire
CV21 3XH – United Kingdom
Tel: +44 1926 338 609
E-mail: uk@gys.fr



GYS ITALIA

Vega – Parco Scientifico
Tecnologico Di Venezia
Via Delle Industrie, 25/4
30175 Marghera – VE Italy
Tel: +39 041 53 21 565
E-mail: italia@gys.fr



GYS CHINA

Lot n°15
6666 bd Songze
201706 Qingpu Shangai
China
Tel: +86 6221 4461
E-mail: contact@gys-china.com.cn



GYS IBÉRICA

Avenida Pirineos 31
Nave 9
San Sebastian de los Reyes
28703 Madrid - Spain
Tel: +34 917-409-790
E-mail: iberica@gys.fr